



ZEV
TECHNOLOGIES

CORE ELITE AEG

Carbine (14.5 inch)/SBR (10.5 inch)/CQB (7.5 inch)

Instruction Manual

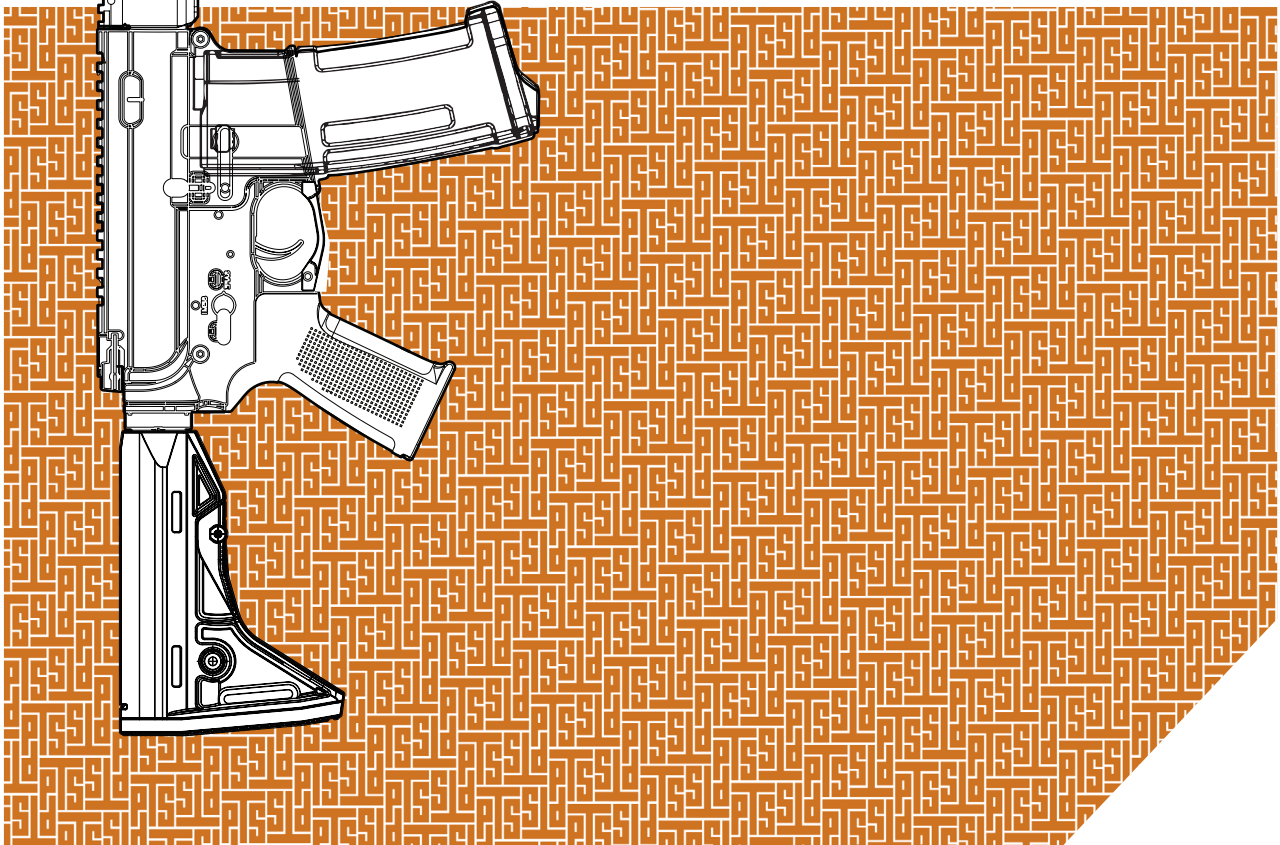
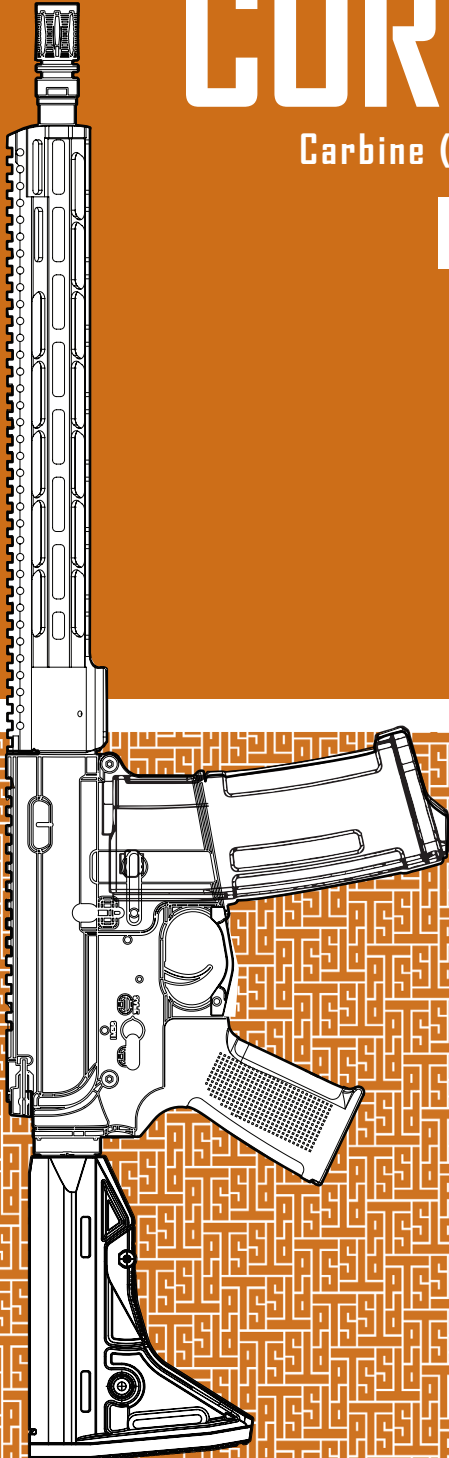

CORE FEATURES

- Official ZEV Technology licensed electric airsoft rifle
- Aluminum upper & lower receivers with authentic ZEV Technology engravings
- Outer Barrel with Bronze Color Finish
- 6.03mm diameter Inner Barrel
- Rear Wired & Li-Po Ready – recommend 7.4v-11.1v Li-Po batteries (15C)
- Steel Sector Gear, full metal tooth rack polycarbonate piston, 14 MIM Steel Piston Teeth
- Functional bolt stop with steel bolt cover hold open for easy hop-up access
- Shooting modes – Safe / Semi-Automatic / Fully- Automatic
- Electronic Trigger MOSFET unit (non-programmable) – For faster trigger responses
- PTS ZEV Wedge Lock Rail - M-LOK compatible skeletonized lightweight handguard
 - 7inch rail for 7.5inch barrel model
 - 9.5inch rail for 10.5inch barrel model
 - 12inch rail for 14.5inch barrel model
- PTS ZEV Slide Lock Charging Handle (AEG) - fully ambidextrous controls
- PTS ZEV Single Stage Rifle Trigger (SSR) – adjustable trigger pull for customizable trigger responsiveness
- PTS Enhanced Polymer Stock – Compact (EPS-C) - lightweight and slim
- PTS Enhanced Polymer Trigger Guard (AEG) - Optimized for use with gloves.
- PTS Enhanced Polymer Magazine (EPM) AEG - 150 rounds capacity high ROF capability
- PTS Enhanced Polymer Grip (EPG) for 14.5inch barrel model
- PTS Enhanced Polymer Grip-Compact (EPG-C) for 7.5 / 10.5inch barrel model

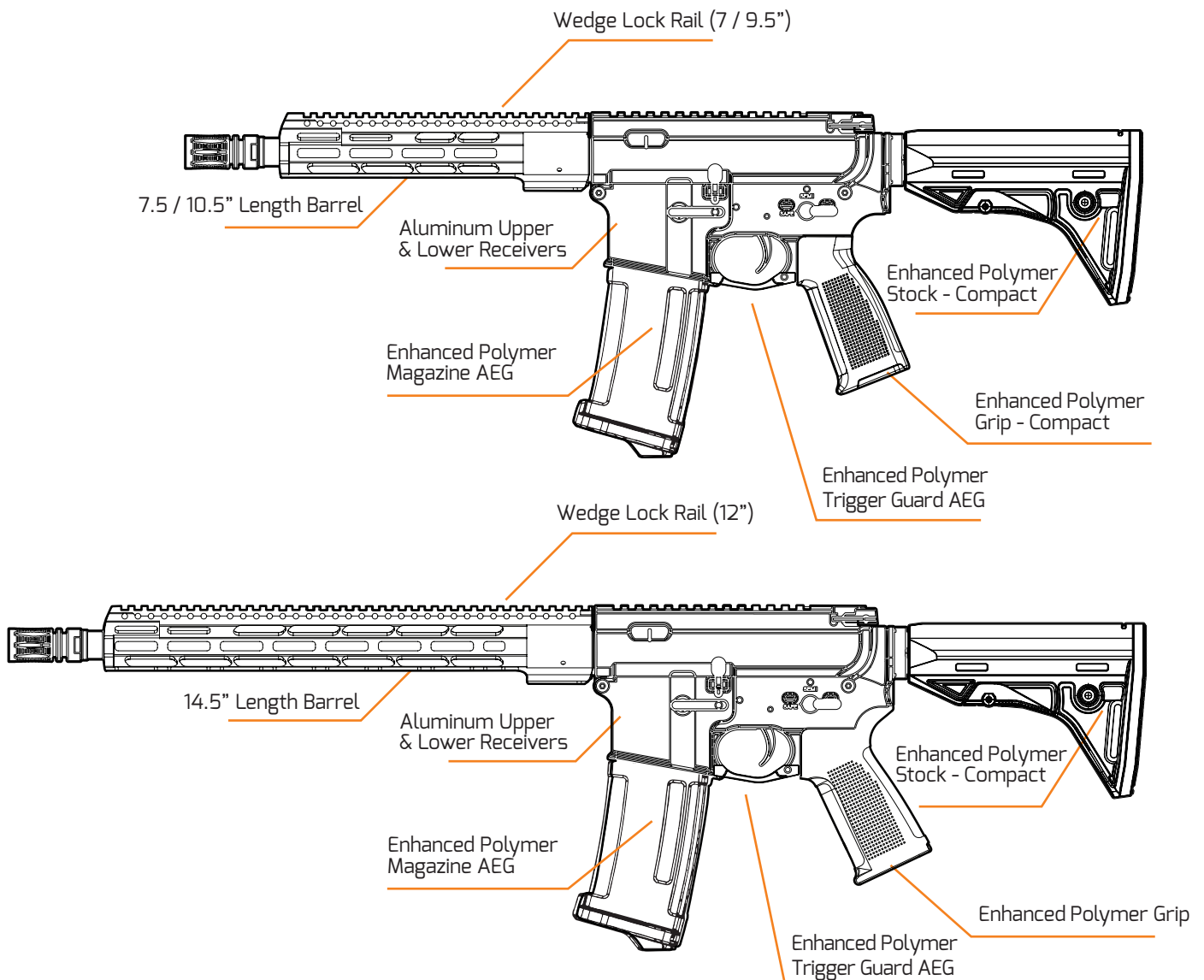

SAFETY INSTRUCTIONS AND HANDLING

You should be fully familiar with the proper and safe handling of your airsoft gun. The basic principles of gun safety require you to always apply the following rules when handling airsoft guns:

Always treat an airsoft gun as if it were loaded.

Always set the safety selector on an airsoft gun to "SAFE" when loading it so that there can be no risk of an unintentional discharge.

Keep your finger off the trigger and outside the trigger guard until you are ready to shoot.

Always keep the muzzle pointed in a safe direction.

Never aim your airsoft gun at persons, animals or property. To avoid ricochets, never fire at smooth, hard surfaces or water.

Before you discharge your airsoft gun, make sure that the target and surrounding area is safe.

Always be aware of your target's foreground and background.

Proper eye protection should always be worn when firing an airsoft gun.

Always store your airsoft gun in a safe place, in an unloaded condition and out of reach from children.

This airsoft gun (along with its operating instructions) may only be handed over to adults and who are fully familiar with the handling of it.

Modifications and/or repairs to the airsoft gun should only be completed by authorized agencies or by a skilled gunsmith.

Never leave a loaded airsoft gun unattended.

CAUTION

You must be 18 years or older to purchase this airsoft gun.

Any alteration or conversion done to this airsoft product that leads to a different classification of the airsoft gun/weapon in regards to the applicable firearms legislation may render it illegal. If these circumstances occur, the manufacturer's warranty becomes immediately null and void.

WARNING

Do not brandish or display this airsoft product in public - it may confuse people and may be a crime in your area. Police and others may view it as a firearm and they may react under that assumption.

Do not change the coloration and markings to make it look like a real firearm. That is dangerous and may be a crime.

Observe safe firearm handling practices at all times. Failure to do so may result in serious bodily injury or death.

PTS is not responsible for injury, death or property damage resulting from faulty installation, misuse, illegal use, or modification of this product.

PTS products feature design modification and/or material construction that renders them incompatible with real firearms.

DO NOT attempt to install, modify, or otherwise adapt PTS products for use on real firearms, as damage to the weapon and/or serious personal injury may occur.

ADJUSTING THE EPS-C POSITION

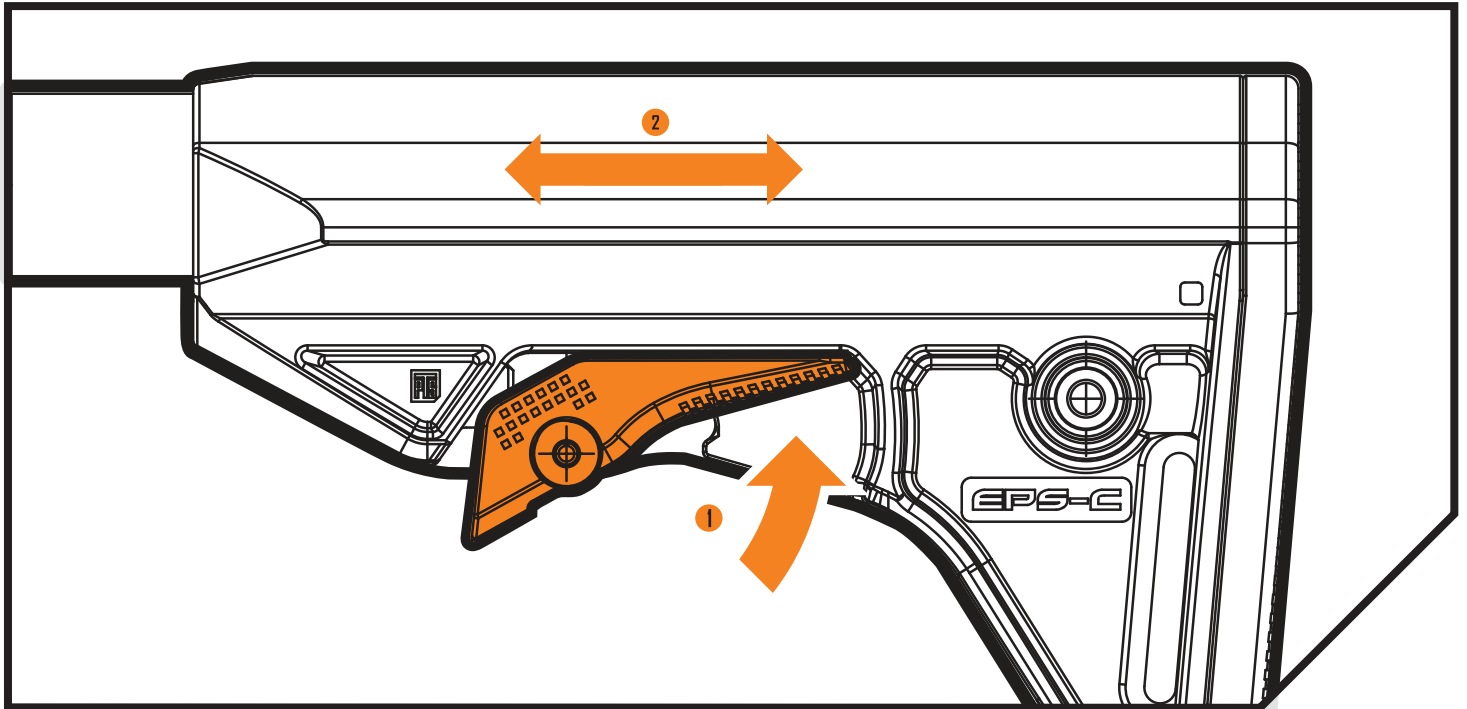

Holding up the backside of the lever to adjust the position of the stock onto the buffer tube

ATTACHING OR DETACHING THE EPS-C

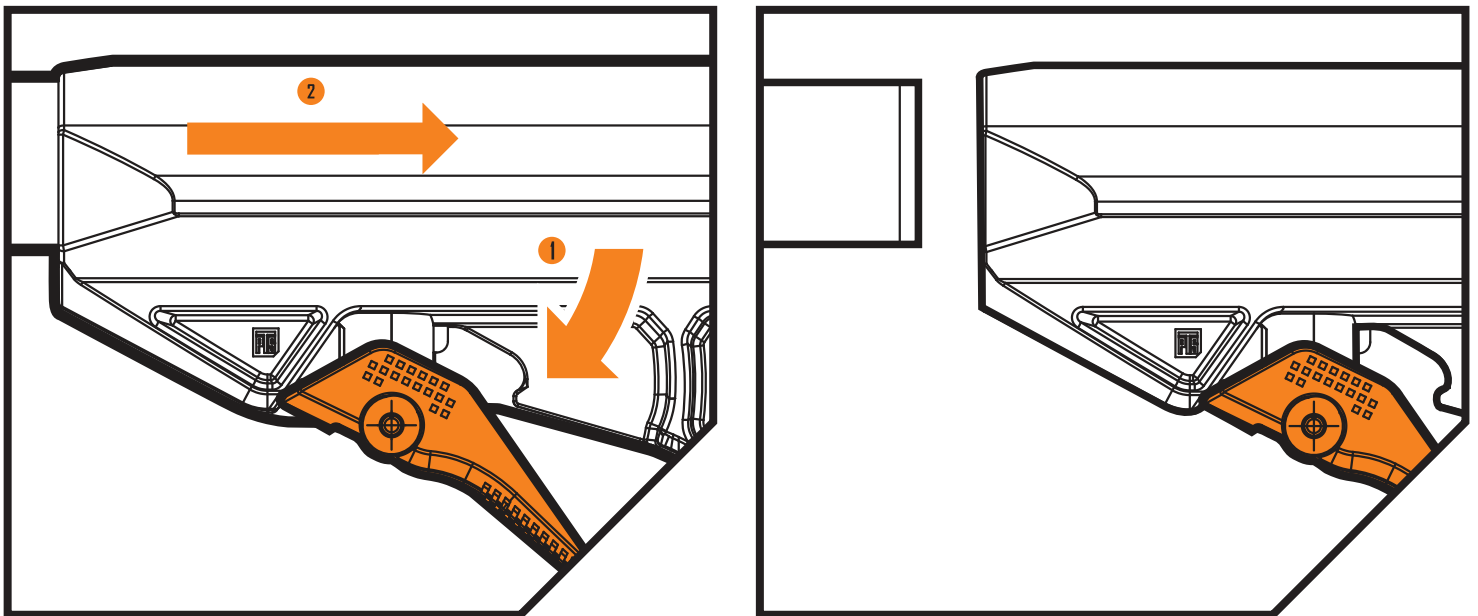

Pulling Down the backside of the lever to install or detach from the rifle buffer tube

BATTERY INSTALLATION

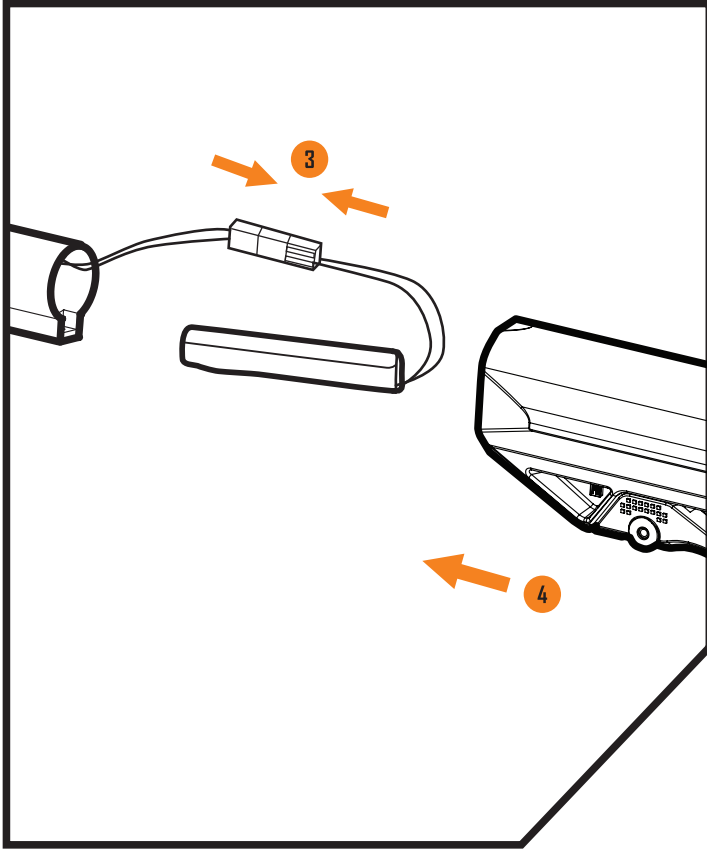

- 1 Detach the PTS EPS-C from your PTS ZEV Core Elite rifle buffer tube by pulling down the backside of the adjustment lever of the stock.
- 2 Detach the tube cap, pull out slowly the battery connector which is located in the tube. Connect with your fully charged 11.1v Li-Po battery.
- 3 Carefully put the connected battery and the wire into the buffer tube and re-install the tube cap.
- 4 Re-install the PTS EPS-C to the rifle buffer tube.

SAFETY SELECTOR

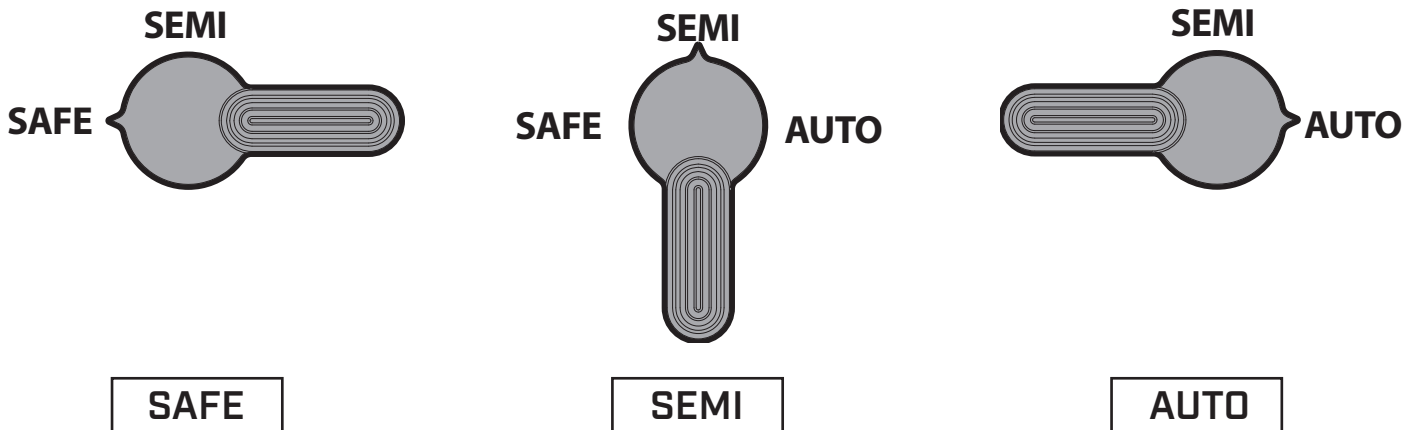

The PTS ZEV Core Elite AEG has three fire control settings: Safe (the gun can not be fired), Semi-Automatic (the gun will fire once per trigger pull), and Fully Automatic (the gun will continue to fire while the trigger is depressed).

LOADING AND UNLOADING THE MAGAZINE FROM THE RIFLE

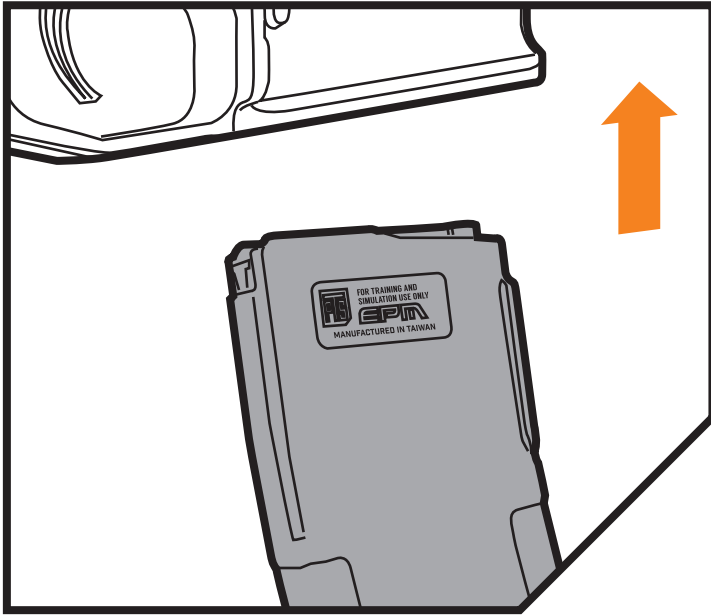

The PTS ZEV Core Elite Rifle works with standard M4/M16 style AEG magazine, including PTS EPM (included with the rifle), EPM1, EPM1-S AEG. Simply insert the magazine into the magazine well. When it's fully seated, the magazine catch will lock the magazine in place.

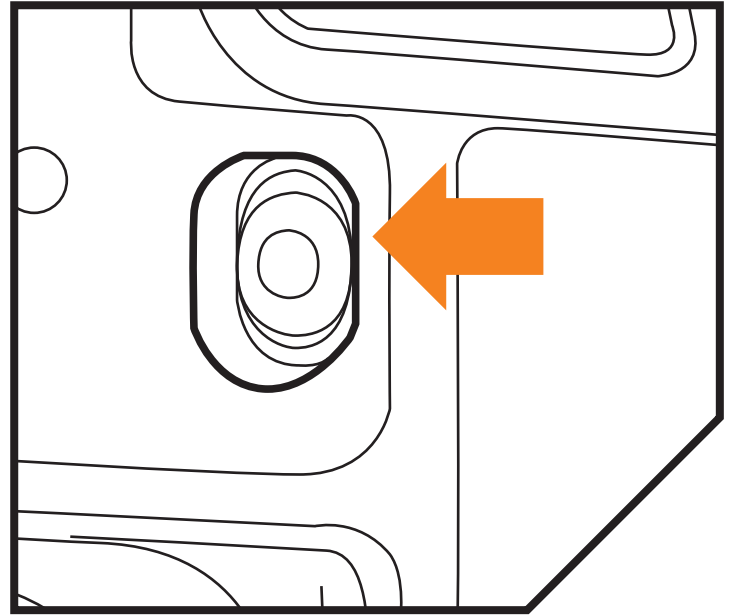

Depressing the magazine release button, releases the magazine which can then be removed from the gun by pulling the magazine downwards.

LOADING THE AIRSOFT MAGAZINE

Only use good quality 6mm airsoft BB pellets with your PTS ZEV Core Elite. Using a BB loader, feed the 6mm airsoft BBs into the magazine. The magazine included with the PTS ZEV Core Elite is a 150 round PTS Enhanced Polymer Magazine.

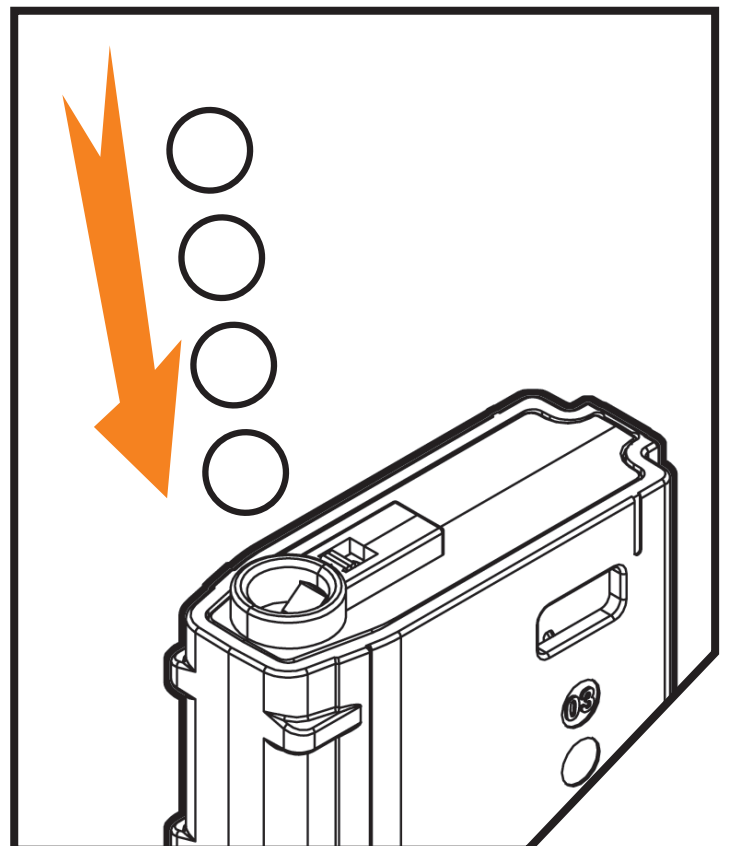

OPENING THE CHAMBER AND HOP-UP ADJUSTMENT

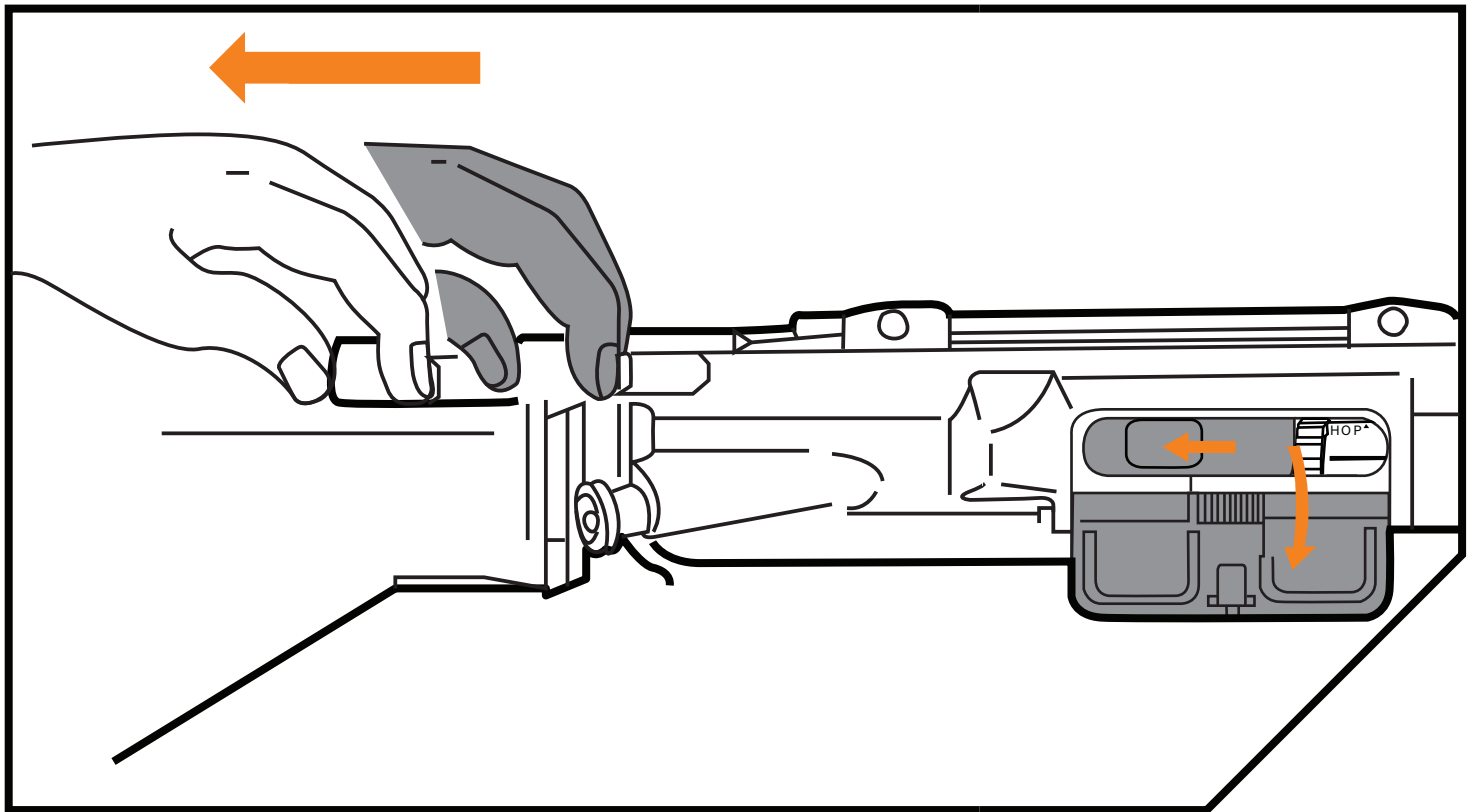

Within the PTS ZEV Core Elite's shell ejection port is a replica bolt that conceals the AEG's Hop-Up unit. To open the chamber, pull back the charging handle which will lock the replica bolt in the rear position.

The hop-up unit is now accessible and user can adjust the hop-up's setting for optimal performance. Rotate the hop-up unit's dial counter-clockwise to increase hop-up effects and rotate it clockwise to decrease the hop-up effects.

To determine which way to adjust the hop-up, fire a few rounds in a safe direction, if the projectiles drop down prematurely, you will have to increase the hop-up (rotate the dial counter-clockwise). If the projectiles curve upwards, you will have to decrease the hop-up (rotate the dial clockwise).

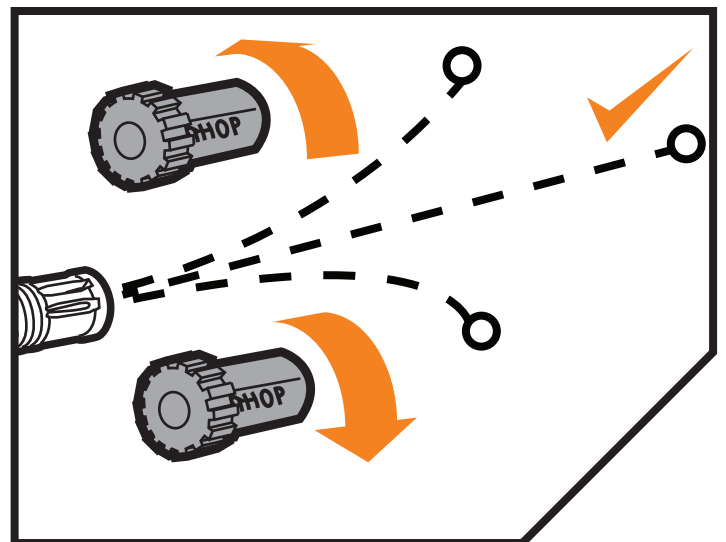

The ideal setting is when the rounds fired maintain a relatively flat trajectory, essentially a "sweet spot" between too much and too little hop-up. Please keep in mind that any hop-up setting will behave differently from one ammo weight to another (eg. 0.2gram BBs versus 0.25gram BBs). If the hop-up has been adjusted for ideal shot trajectory with a certain weight BBs, changing the weight of the BB may require adjustment of the hop-up setting.

To close the replica bolt cover, push the bolt release button which is located at the opposite side of the receiver which will spring the replica bolt cover back into the closed position.

GENERAL MAINTENANCE & TROUBLE SHOOTING

Occasional maintenance of your PTS rifle using silicone oil lubricant is highly recommended to ensure your AEG is running optimally. There are various brands and types of silicone oil on the market for various end users, however we recommend only using silicone oil manufactured specifically for airsoft purposes. To properly lubricate your PTS rifle, apply a small amount of silicone oil onto the hop-up chamber via the BB feed opening. Loading the magazine and fire equivalent to 1 fully load magazine after.

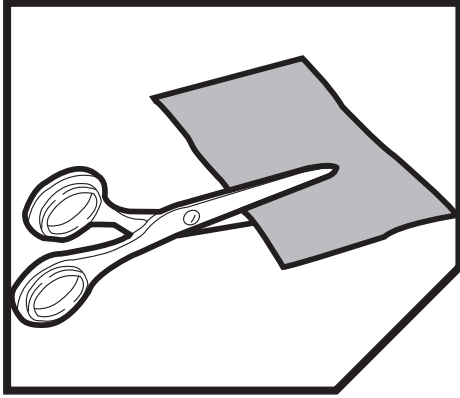

Cotton cloth

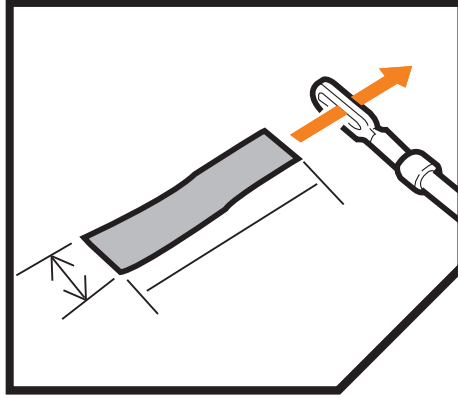

Width: approx. 10mm

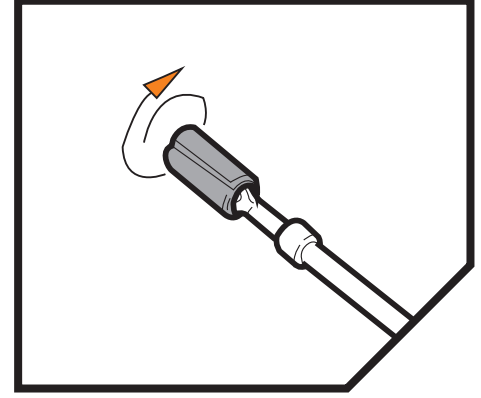

Wind the cut cotton cloth

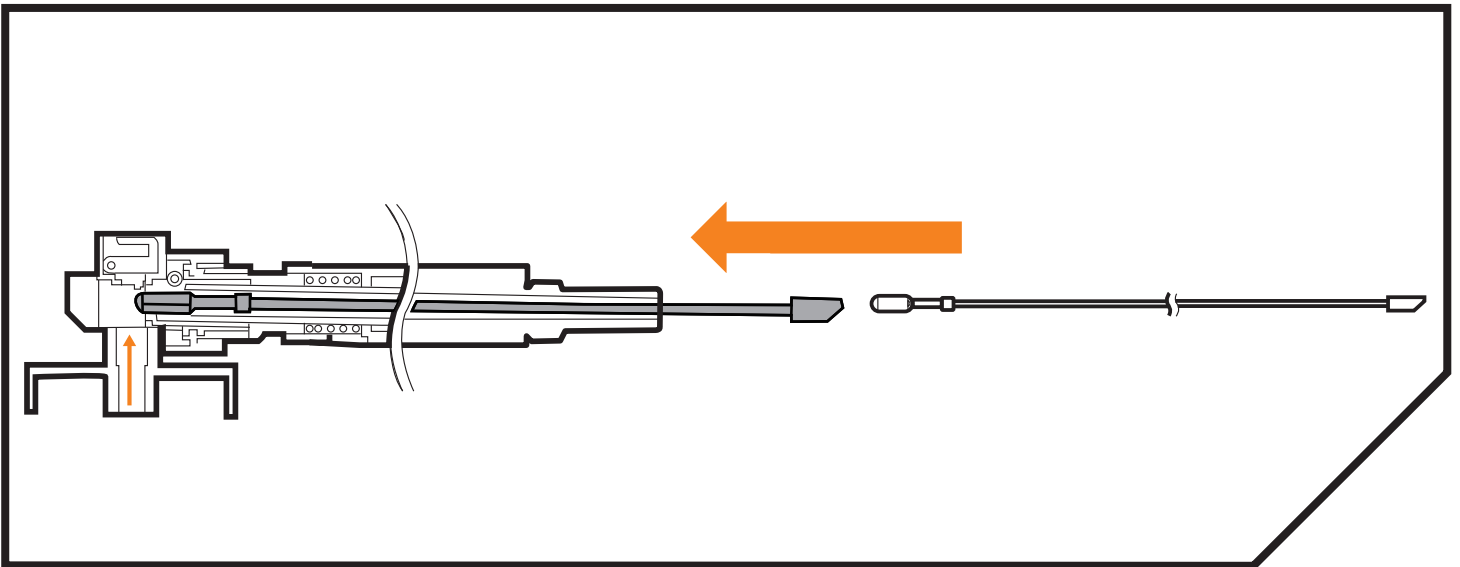

To complete the cleaning, use the cleaning rod with cotton cloth at the loop (see diagram) to remove excess lube from inside the barrel.

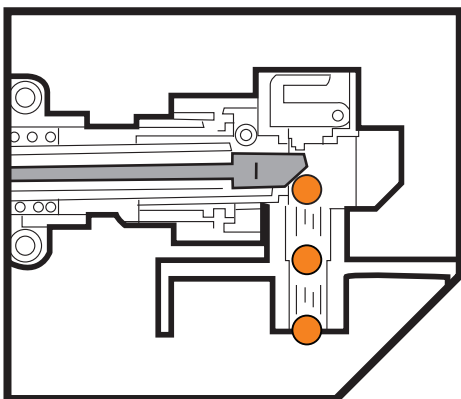

Removing clogged BBs

- 1 Turn off the hop-up (Hop Off)
- 2 Remove the magazine from the gun
- 3 Insert the cleaning rod (angled point forward and face down) into the barrel
- 4 Push any jammed BBs from the inner barrel or hop up unit so that they will fall out of the empty magwell.

GENERAL MAINTENANCE & TROUBLE SHOOTING

Fine Adjustment of Gear Engagement

Recommend doing this fine adjustment only when the motor sounds noisy or whiny after operations for a long period of time.

Turn the screw at the bottom of the motor grip to clockwise or counterclockwise while you pull the trigger; and stop turning when the motor noise is gone. Warning: excessive tightening of the screw may damage the motor.

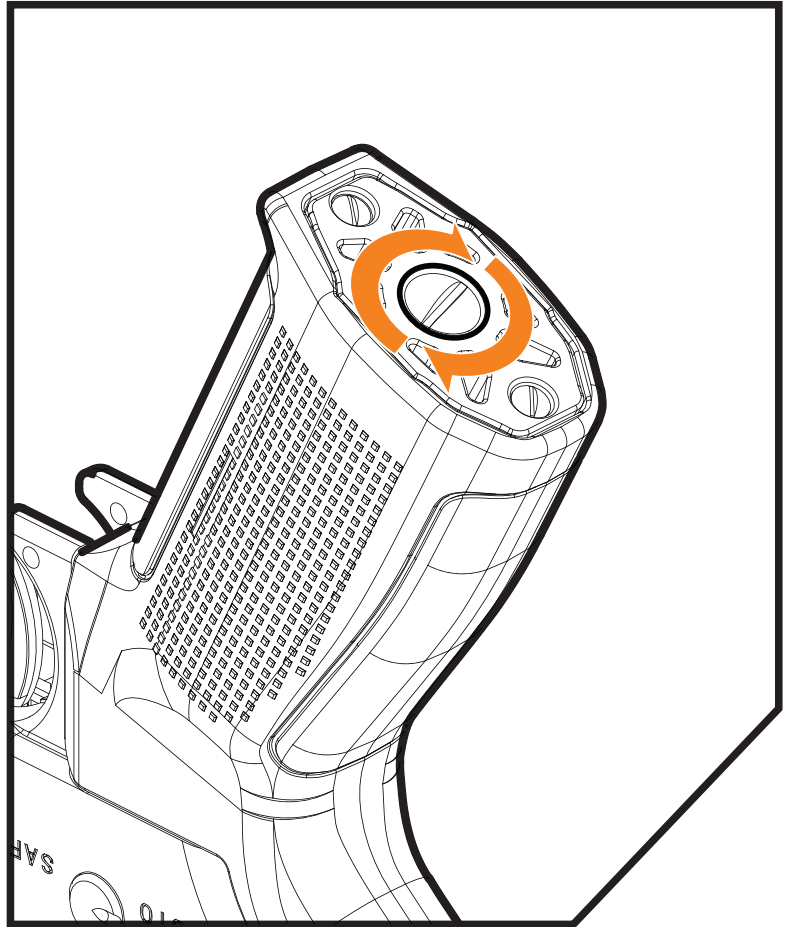

HOW TO ADJUST THE ADJUSTABLE TRIGGER

The adjustable trigger allows you to tailor the trigger pull length to suit your taste simply by turning an 1.5mm allen screw behind the trigger as shown in the pictures.

Diagram 1. Turning the allen screw counterclockwise for longer trigger response

Diagram 2. Turning the allen screw clockwise for shorter trigger response

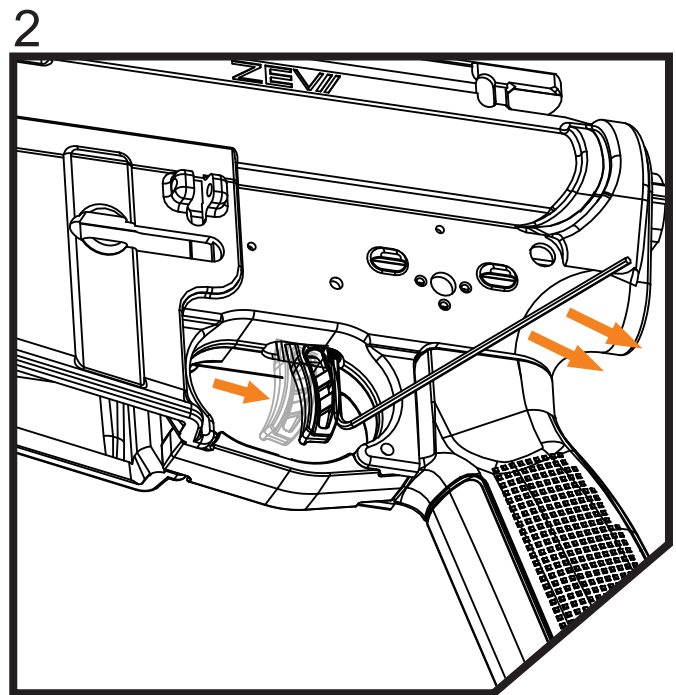
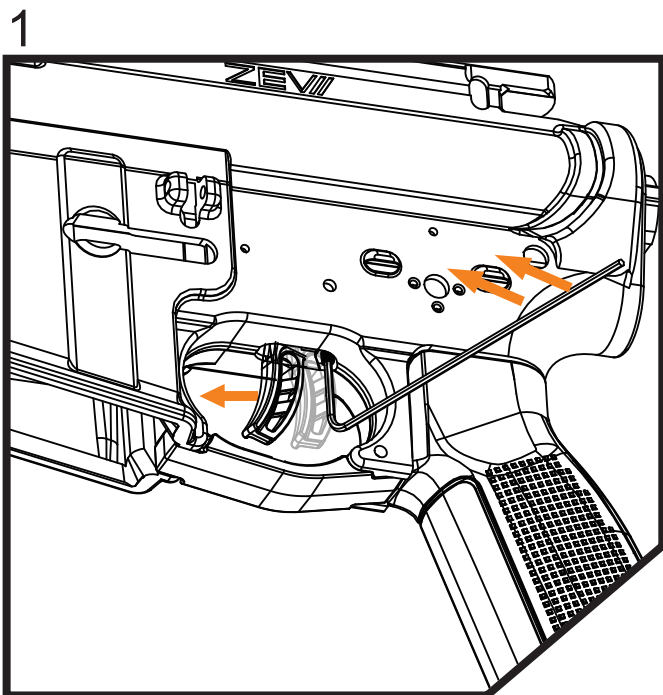

EXPLODED VIEW

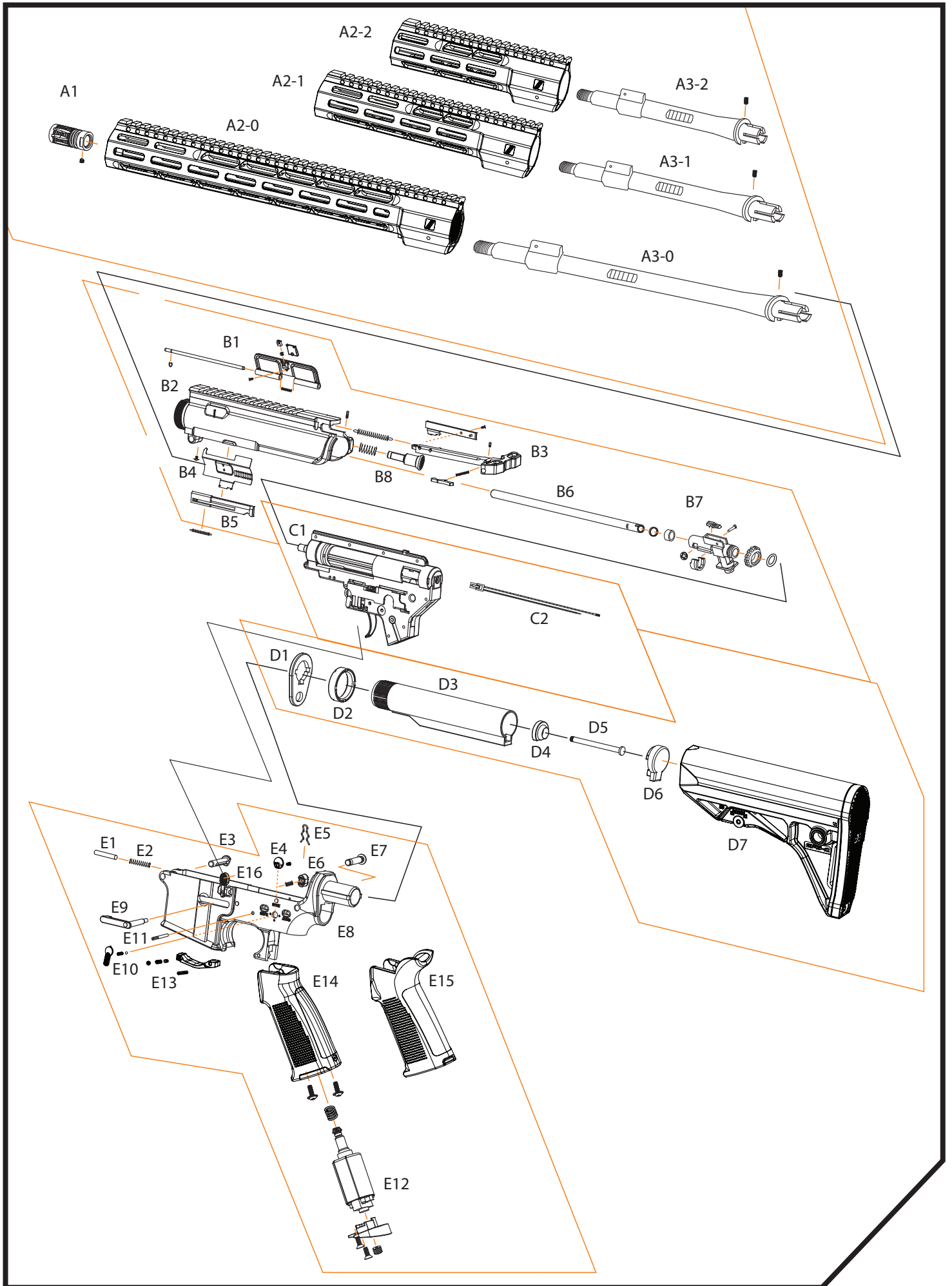

PARTS LIST CATALOGUE

A1	Flash Hider	C1	Gear Box Set	E1	Hold Pin
A2-0	PTS ZEV Wedge Lock Rail - 12"	C2	Stock Wiring	E2	Hold Pin Spring
A2-1	PTS ZEV Wedge Lock Rail - 9.5"			E3	Frame Lock Pin (Front)
A2-2	PTS ZEV Wedge Lock Rail - 7"	D1	Stock Plate (Type A)	E4	Selector Plate
A3-0	Outer Barrel - 14.5"	D2	Buffer Tube Lock Ring	E5	Push Pin Retainer Clip
A3-1	Outer Barrel - 10.5"	D3	Buffer Tube	E6	Mag Catch Button
A3-2	Outer Barrel - 7.5"	D4	Buffer Tube Pin Cap	E7	Frame Lock Pin (Rear)
		D5	Buffer Tube End Pin	E8	Lower Frame
B1	Port Cover	D6	Buffer Tube End Cap	E9	Mag Catch
B2	Upper Frame	D7	PTS EPS-C Stock	E10	Fire Selector
B3	PTS ZEV Slide Lock Charging Handle			E11	Gear Box SetPin
B4	Bolt Cover			E12	Motor
B5	Bolt Cover Holder			E13	PTS EP Trigger Guard
B6	Inner Barrel			*#E14	PTS EP Grip-C (EPG-C)
B7	Hop-Up Module			*#E15	PTS EP Grip (EPG)
B8	Assist Knob Set			E16	Bolt Catch

*#E14 - For model with wedge lock rail 7" & 9"

*#E15 - For model with wedge lock rail 12"



ZEV Technologies, Inc. is one of the leading companies in innovating and producing the highest quality weapon accessories and parts.



As the worldwide exclusive licensee of a wide variety of airsoft products and brands, PTS prides itself in helping create the most authentic experience possible - both on and off the battlefield. Nothing else handles like PTS because nothing else is made like PTS, guaranteed. Each and every brand in the PTS family must pass rigorous testing requirements. And it's only the most realistic, precision engineered and innovatively designed that make the cut. In the end, you can be assured that the PTS family of brands offers a singular opportunity to own one of the finest, most trusted, field-tested brands ever assembled. Welcome to the PTS experience.

WARNING!

User restricted to 18 years of age or older.

You must read through this instruction Manual before operating this airsoft gun.

Always wear proper eye and face protection.

Obey all your local laws and regulations regarding ownership and usage of airsoft guns.

Misuse or careless use may result in serious injury or other consequences.

MADE IN CHINA

www.ptssyndicate.com

sales@ptssyndicate.com

License: ZEV® logo and related brand names are trademarks of ZEV Technologies, Inc. in the United States and/or other countries and are used for airsoft replicas under exclusive worldwide license by PTS Syndicate, Ltd. www.ptssyndicate.com